

R-CFS+KERII Hybrid resin with Post-Installed Rebars

High performance hybrid resin approved for use with post-installed rebar connections



Approvals and Reports

• ETA-17/0874



Product information

Features and benefits

- Approved for use with post-installed rebars in concrete (EAD 330087-00-0601)
- Opportunity to use it in lower temperatures (to -20°C in winter version) allow you to apply throughout the year
- Very high load capacity
- Suitable for use in dry or wet substrates and water filled holes
- Rapid bonding time enables quick execution of works
- Winter version can be used in warmer temperatures for faster curing
- Approved for 3 types of hole cleaning (including use of dustless drill bit)
- Unique soft foil pack for less waste
- Effortless extrusion due to the patented self-opening system with manual or battery dispenser guns

Applications

- Post-installed rebar connections
- Rebar
- Rebar missed-outs
- Extending existing buildings and structures.
- Renovation and modernization of bridges, buildings.
- Platforms
- Safety barriers
- Barriers

Base materials

- Approved for use in:**
- Concrete C12/15-C50/60

Installation guide

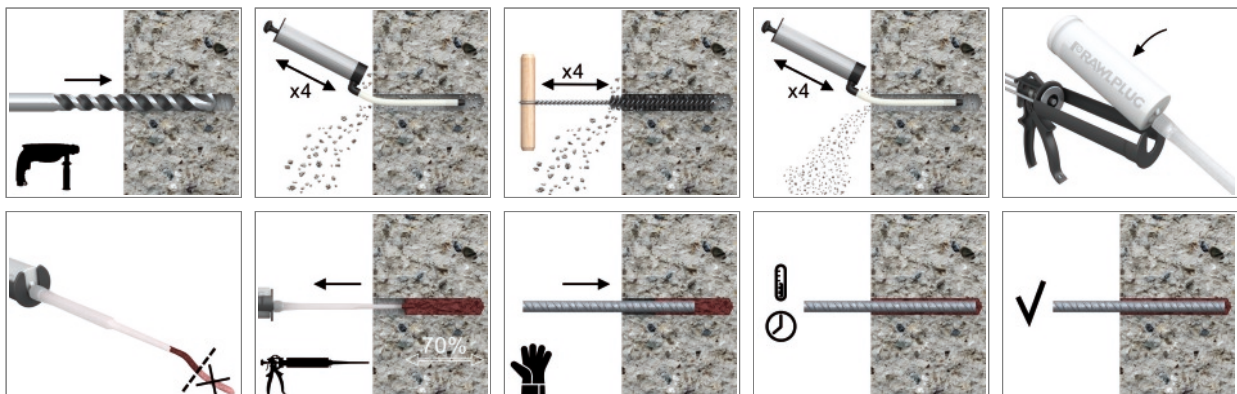

Product information

1. Drill hole to the required diameter and depth for rebar size being used.
2. Clean the drill hole thoroughly with brush and hand pump at least four times before installation
3. Insert cartridge into gun and attach nozzle.
4. Dispense to waste until even colour is obtained (min. 10 cm)
5. Insert the mixer nozzle to the bottom of the drill hole and inject resin, slowly withdrawing the nozzle as the hole is filled to 70% of its depth.
6. Immediately insert the rebar, slowly and with slight twisting motion. Remove any excess resin around the hole before it sets and leave it undisturbed until the curing time elapses.

Product Code	Resin	Description / Resin Type	Volume
			[ml]
R-CFS+KERII-600-S	R-CFS+KERII	R-KER II Hybrid Resin for High Temperature (Summer) / Slow Cure Styrene Free Hybrid Resin	600

Product commercial data

Product Code	Volume [ml]	Quantity [pcs]			Weight [kg]			Bar Codes
		Box	Outer	Pallet	Box	Outer	Pallet	
R-CFS+KERII-600-S ¹⁾	600	1	1	36	10.0	10.0	390.0	5906675464824

1) ETA-17/0874